



Cork Handmade Wallpaper

Size

0,75 x 5,5 m

Producer

Corkart - Indústria de Cortiças S.A.

Address

Parque Industrial de Vendas Novas, lote nº 20
7080-341 Vendas Novas, Portugal

Tel. +351 265 809 215

E-mail info@corkart.pt



CORKART
corkart.pt

RULES FOR THE INSTALLATION

Please read these instructions carefully before starting the installation.

1. Tools Required



SEAM ROLLER



LEVEL



PENCIL



SMOOTH BRUSH



TAPE MEASURE



RULER



SHORT HAIR MOHAIR ROLLER



CLOTH



CRAFT KNIFE



BROAD KNIFE

Cork Handmade Wallpaper

2. Substrates

The substrate must be flat, smooth, permanently dry, firm and free of cracks, dirt and adhesion-inhibiting substances. Old chalk, adhesive, oil and paint traces should be roughened with a wire brush, to obtain a substrate with absorption. Waste oil must be completely removed. The surface of any suitable type of substrate must be structurally sound and strong, secured, fixed, clean and free of all oil, grease, wax, dirt, varnish, lacquer, or any contaminant that can act as a bond inhibitor. The irregularities should be leveled with an appropriate leveling compound. Gypsum plaster, and plaster card tiles as well as other highly absorbent substrates should be primed. Refer to the primer package label for dilution and drying time.

3. Laying

Packaged rolls and adhesive must be acclimated at work in a dry, well-ventilated area for a minimum of 48 hours. Remove the rolls from packaging just before starting the installation. During installation, maintain temperature and relative humidity to consistent level with the conditions that will prevail when building is occupied. This means keeping the temperature range of 18°C to 28°C (65°F to 82°F) and the relative humidity range from 35% to 65%.

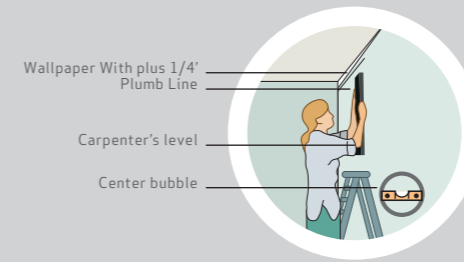

4. Measures

Draw a plumb line (vertical line) at the mark with a level. This is your guide where your two strips of roll will meet.

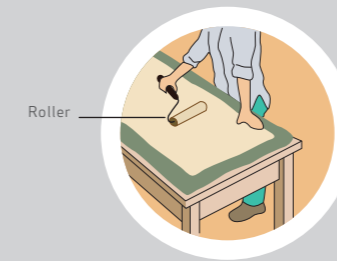

5. Adhesive

Stir the adhesive before use, apply the adhesive Henkel Thomsit PEAC with short hair mohair roller. Avoid pooling of adhesive. Coverage must be 200-250g/m² (sqm).

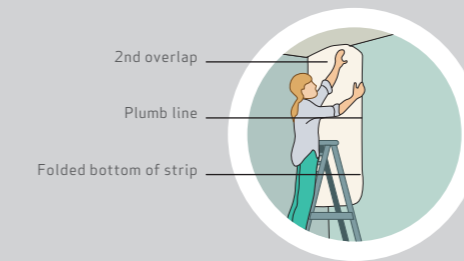

6. Gluing Process

Carefully align the first roll to the marked plumb line. Do not apply too much pressure when installing the rolls in place, so you will be able to remove if necessary. When the roll is in place, press with your hands to ensure that all parts are in contact with the adhesive on the wall.

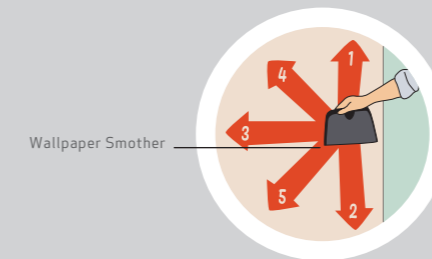

Go with the brush over the entire area of the roll. Then use the seam roller to ensure that the roll is fixed to the wall. Proceed the same way with the next rolls.

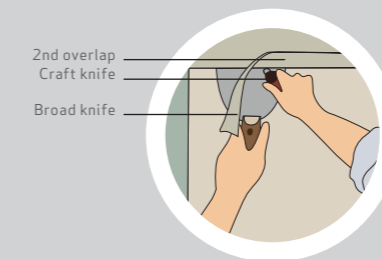
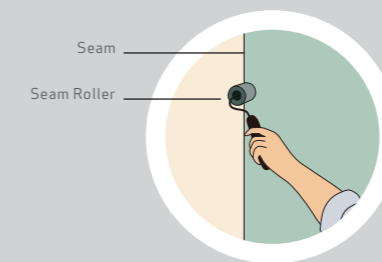

7. Cuts

Cut the rolls to the required size, proceed as shown in the picture.